

ROAD SURFACE CONDITION RANKING

* ROAD SURFACE CONDITION RANKING BASED ON VISUAL INSPECTION OF ROADS.

* RANKING IS FROM ONE (1) THROUGH FIVE (5) WITH ONE (1) BEING THE WORST CONDITION AND FIVE (5) BEING THE BEST CONDITION.

- ① Potholes, multiple patches, poor trenches and/or severe cracking.
- ② No potholes, several patches, average trenches and/or moderate cracking.
- ③ No potholes, few patches, well laid trenches and/or mild cracking.
- ④ No potholes, minimal patches, no trenches, and/or minimal cracking (typically along the centerline and expansion joints of concrete roads overlaid with asphalt).
- ⑤ "Near new" condition with no potholes, no patches, no trenches and/or virtually no cracking.

ROADWAY PAVING PROJECTS 2000-2011

UPDATED FEBRUARY 17, 2011

LEGEND:

-  IMPROVEMENTS TO KAMM AVENUE (UNDER DESIGN)
-  2010 ROADWAY IMPROVEMENTS (UNDER CONSTRUCTION)
-  IMPROVEMENTS TO WILLIAM STREET
-  IMPROVEMENTS TO ROOSEVELT STREET
-  IMPROVEMENTS TO NORTH END DRIVE
-  2009 ROADWAY IMPROVEMENTS
-  2008 ROADWAY IMPROVEMENTS
-  IMPROVEMENTS TO BURTON AVENUE – SECTION II
-  DRAINAGE IMPROVEMENTS TO PAUL AND WILCOX
-  2007 COUNTY ROADWAY PAVING
-  IMPROVEMENTS TO BURTON AVENUE – SECTION I
-  IMPROVEMENTS TO WASHINGTON STREET
-  IMPROVEMENTS TO HILLSIDE AVENUE – SECTION II
-  WATER SYSTEM RECONSTRUCTION PHASE 1 AND 2
-  IMPROVEMENTS TO GASZI AVENUE
-  IMPROVEMENTS TO HILLSIDE AVENUE – SECTION I
-  IMPROVEMENTS TO THE WATER STREET AND CAUSEWAY INTERSECTION
-  WATER SYSTEM RECONSTRUCTION PHASE 1 AND 2
-  2004 COUNTY ROADWAY PAVING
-  2004 MILLING & RESURFACING OF MUNICIPAL ROADS
-  2003 COUNTY ROADWAY PAVING
-  2003 MILLING & RESURFACING OF MUNICIPAL ROADS
-  2002 CAPITAL IMPROVEMENTS
-  2001 MILLING & RESURFACING OF MUNICIPAL ROADS
-  2000 ROADWAY IMPROVEMENTS
-  IMPROVEMENTS TO LEONARDINE AVENUE – SECTION II
-  IMPROVEMENTS TO JOHNSON PLACE AND ZEIGERT STREET

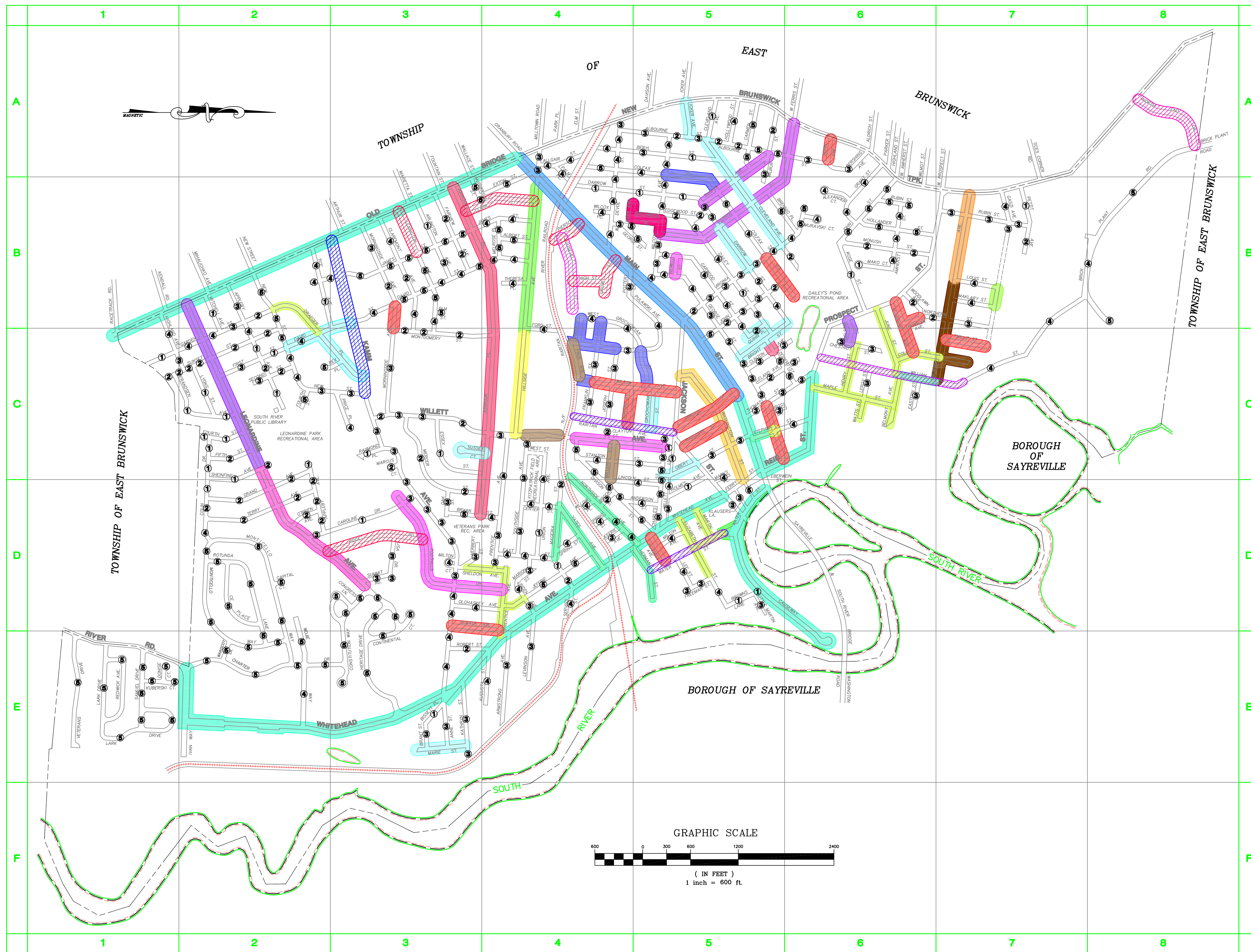

BOROUGH OF SOUTH RIVER

Middlesex County, New Jersey

Prepared By:
DAVID J. SAMUEL P.E.
 Borough Engineer



CONSULTING AND MUNICIPAL ENGINEERS